



Frame Fit Specifications

Advanced ideas require precise execution.

XX™ demands precise frame fit specifications that are unique to XX. These specifications are the result of the innovative and revolutionary technology that makes XX shifting the lightest, fastest, and most precise in the mountain bike market today.

Please take the time to carefully review the frame fit specifications to ensure you have the information you need to build the perfect XX equipped mountain bike. We didn't compromise when developing the XX group; we know you won't either.



XXPONENTIAL
INNOVATION⁴



XX™ Front Derailleur - Low & High Clamp

CLAMP/BODY POSITION*					TIRE CLEARANCE	
Chain Ring	A	B	C	D	E	F
LOW CLAMP	39T	61 mm	76 mm	-	40 mm	33 mm
	42T	67 mm	82 mm			
	45T	73 mm	88 mm			
HIGH CLAMP	39T	114 mm	129 mm	79 mm	Top Pull = 25 mm Bottom Pull = 32 mm	34 mm
	42T	120 mm	135 mm	85 mm		
	45T	126 mm	141 mm	91 mm		

* Be sure to leave adequate clearance between bottle cage mounts and front derailleur clamp.

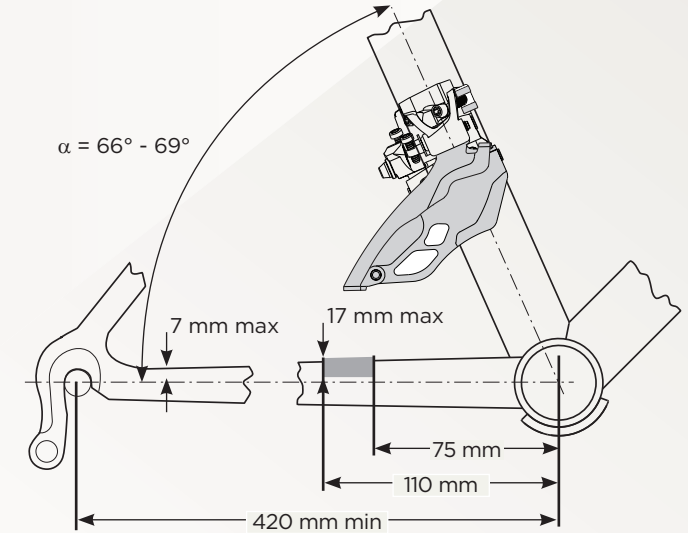

FRONT DERAILLEUR FRAME COMPATIBILITY AND CAPACITY INFORMATION							
	Clamp Diameter	Rear Capacity	Index	Cable Routing	Chain Stay Angle (α)	Chain Line	Material
LOW CLAMP	31.8 mm (use adaptor) 34.9 mm 38.2 mm	10 speed	Yes	Top Pull or Bottom Pull	66° - 69°	49.5 mm	Clamp - Forged Aluminum Cage - Steel
HIGH CLAMP	31.8 mm 34.9 mm 38.2 mm						Clamp - Steel Cage - Steel

XX™ Front Derailleur - Low & High Clamp

LOW CLAMP

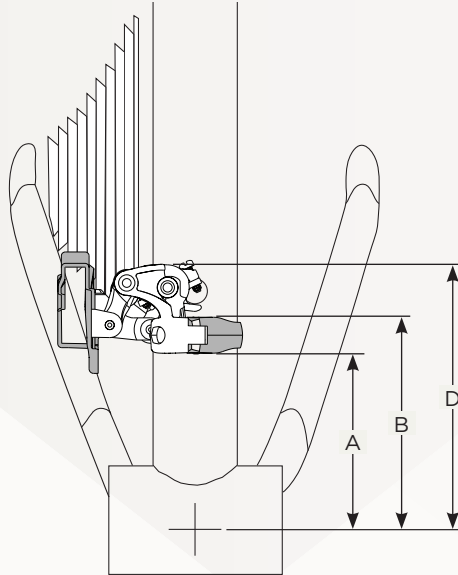
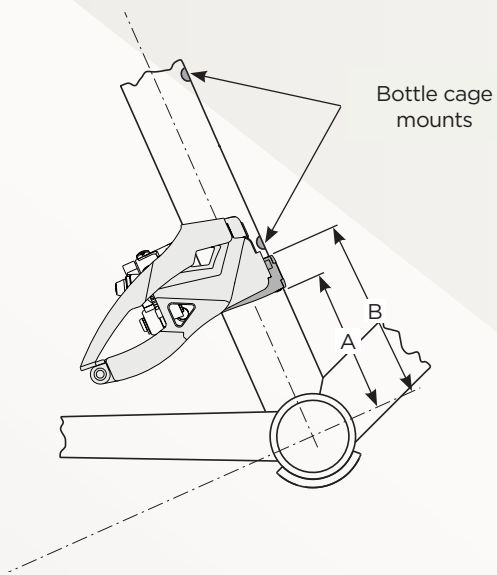

HIGH CLAMP

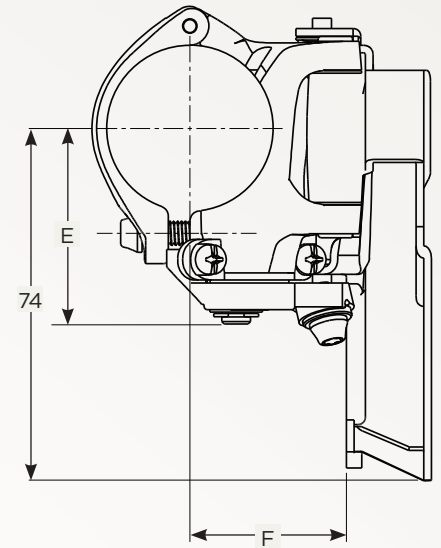
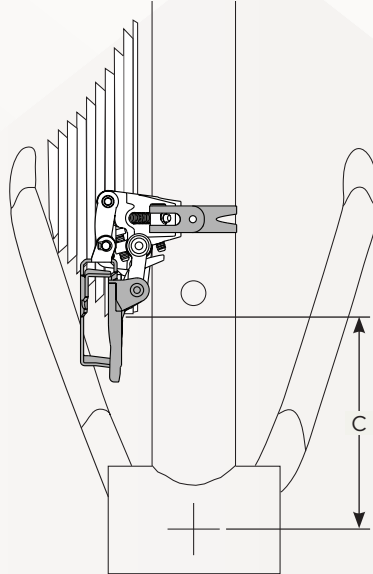
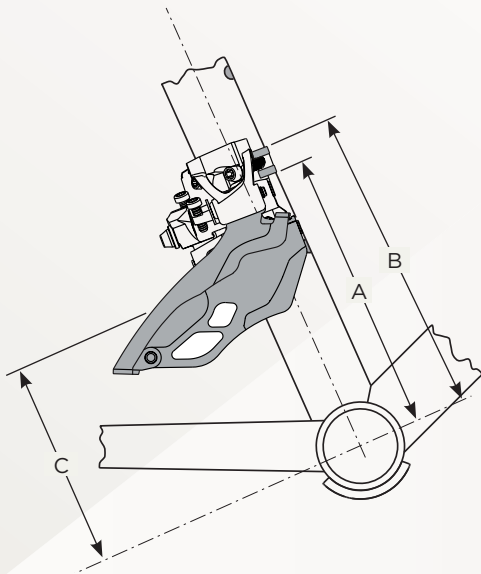

XX™ Front Derailleur - Direct Mount

	MOUNTING HOLE POSITION (SWING ARM FULLY EXTENDED)							FRONT DERAILLEUR CLEARANCE (SWING ARM FULLY COMPRESSED)			
	θ	A	B	C	D		E	F	G	d_{max}	
					68 mm BB shell width	73 mm BB shell width					
DIRECT MOUNT TYPE	S1	$45.5^\circ \pm 1^\circ$	48.9 mm ± 0.15 mm	42.7 mm ± 0.1 mm	63 mm ± 0.2 mm	14.8 mm ± 0.15 mm	17.3 mm ± 0.15 mm	-	65 mm	45 mm	37 mm
	S2	$66^\circ - 69^\circ$ ($\theta = \alpha$)	54 mm ± 0.15 mm	22.1 mm ± 0.05 mm	5 mm ± 0.05 mm	7 mm ± 0.15 mm	9.5 mm ± 0.15 mm	5 mm ± 0.1 mm			
	S3										

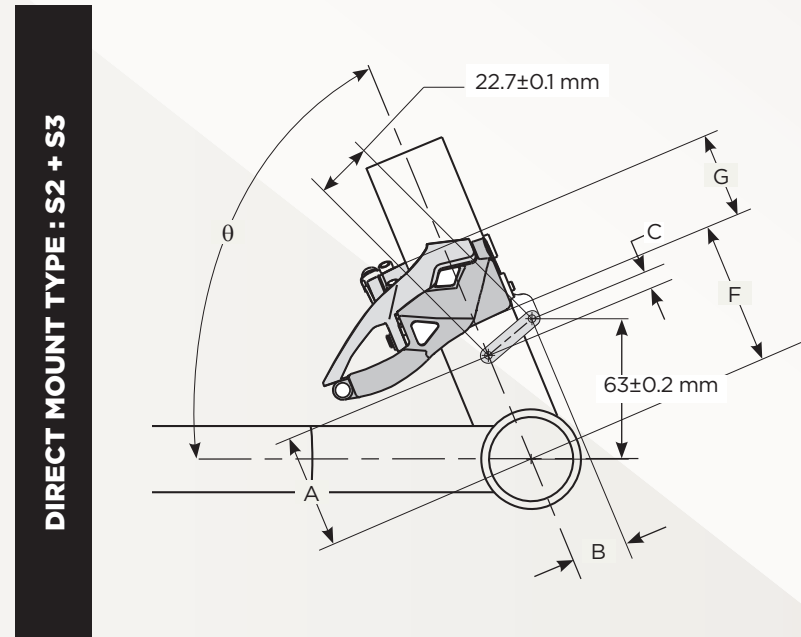
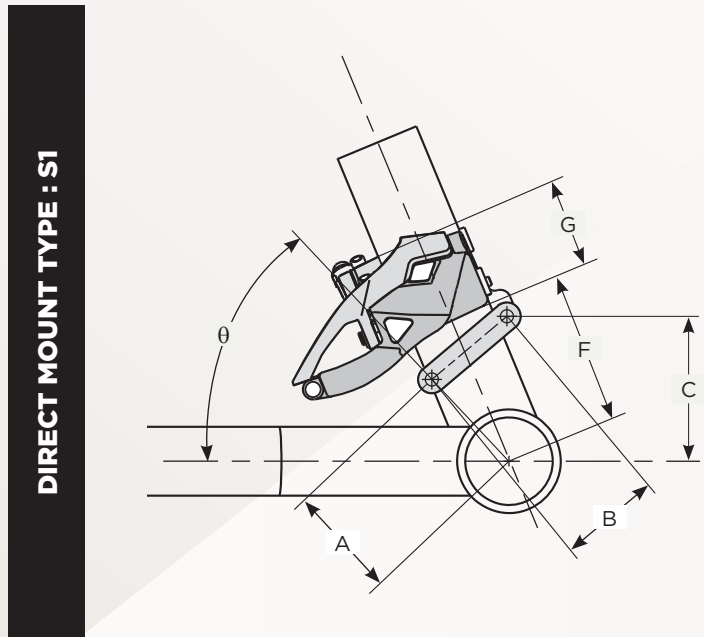

XX™ Front Derailleur - Direct Mount

FRONT DERAILLEUR CABLE ROUTING - BOTTOM PULL (SWING ARM FULLY EXTENDED)							THREAD DIMENSION	TIRE CLEARANCE	
H	I	K Chainring Size			δ	ϵ	L	M	N
		39T	42T	45T					
8 mm	35 mm	94 mm	100 mm	106 mm	10.5° max	10.5° max	M5.0x0.8-6H	40 mm	33 mm

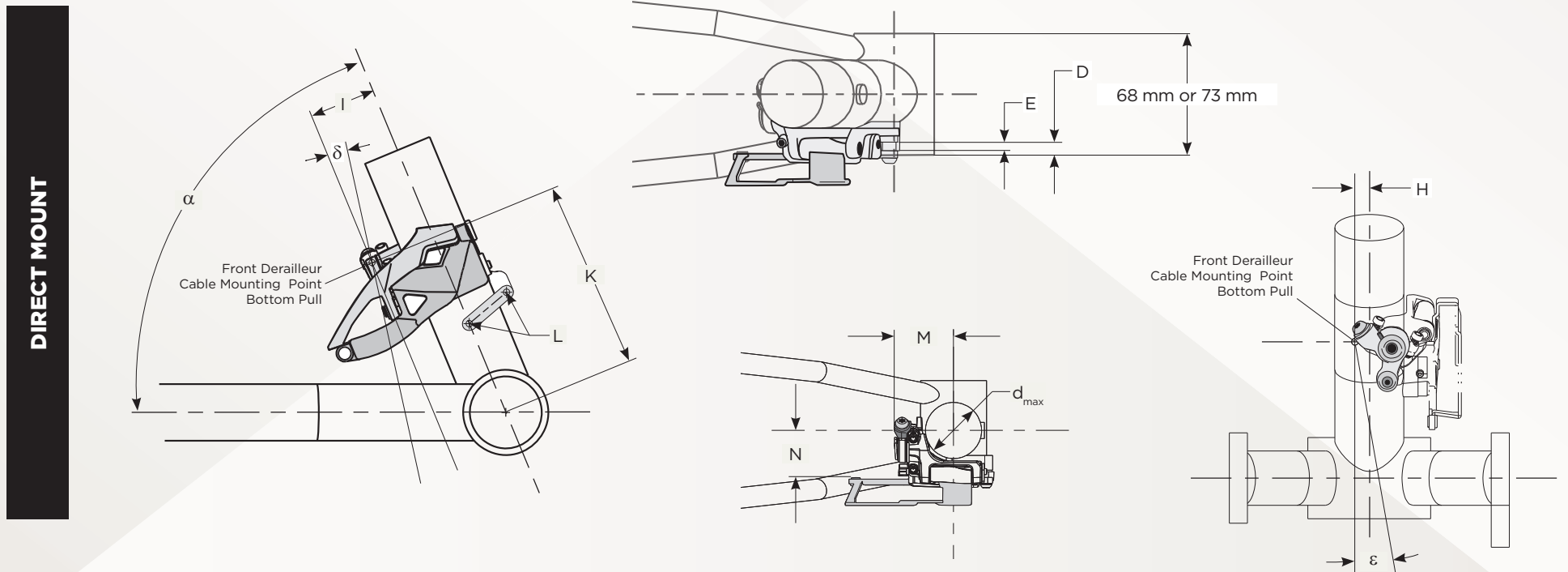

XX™ Front Derailleur - Direct Mount

FRONT DERAILLEUR FRAME COMPATIBILITY AND CAPACITY INFORMATION					
Rear Capacity	Index	Cable Routing	Chain Stay Angle (α)	Chain Line	Material
10 speed	Yes	Top Pull or Bottom Pull	66° - 69°	49.5 mm	Body - Forged Aluminum Cage - Steel

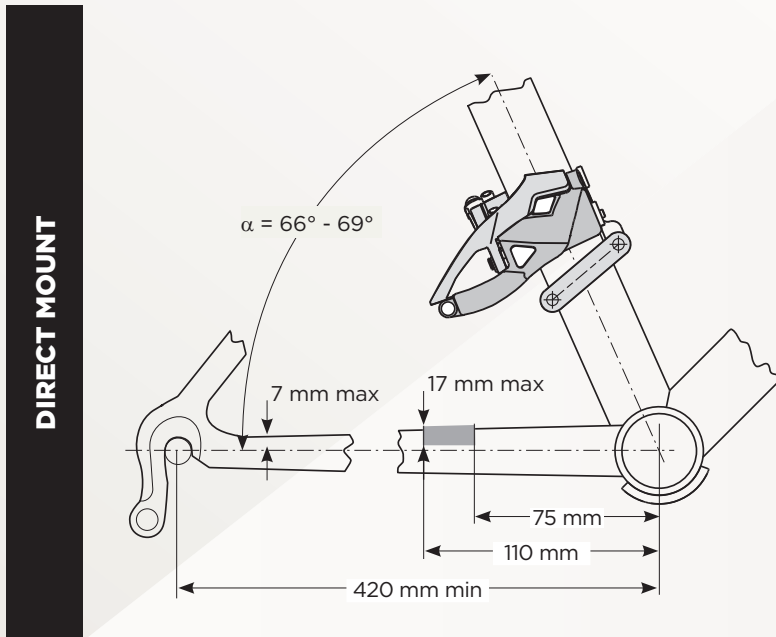

CRANKSET FRAME CLEARANCE INFORMATION										
Chain Ring Combination	L1	L2	L3	L4	W1	W2	W3	W4	W4	W4
26/39	31 mm	55 mm	81 mm	190 mm (175 mm crank arm length)	43.5 mm	44.5 mm	52.5 mm	65.7 mm	69.5 mm	70.5 mm
28/42		60 mm	87 mm							
30/45		64 mm	93 mm							
Q-factor								Q156	Q164	Q166
Bottom Bracket Type(s)								GXP BB30 PressFit™ 30	BB30 PressFit 30	GXP PressFit 30

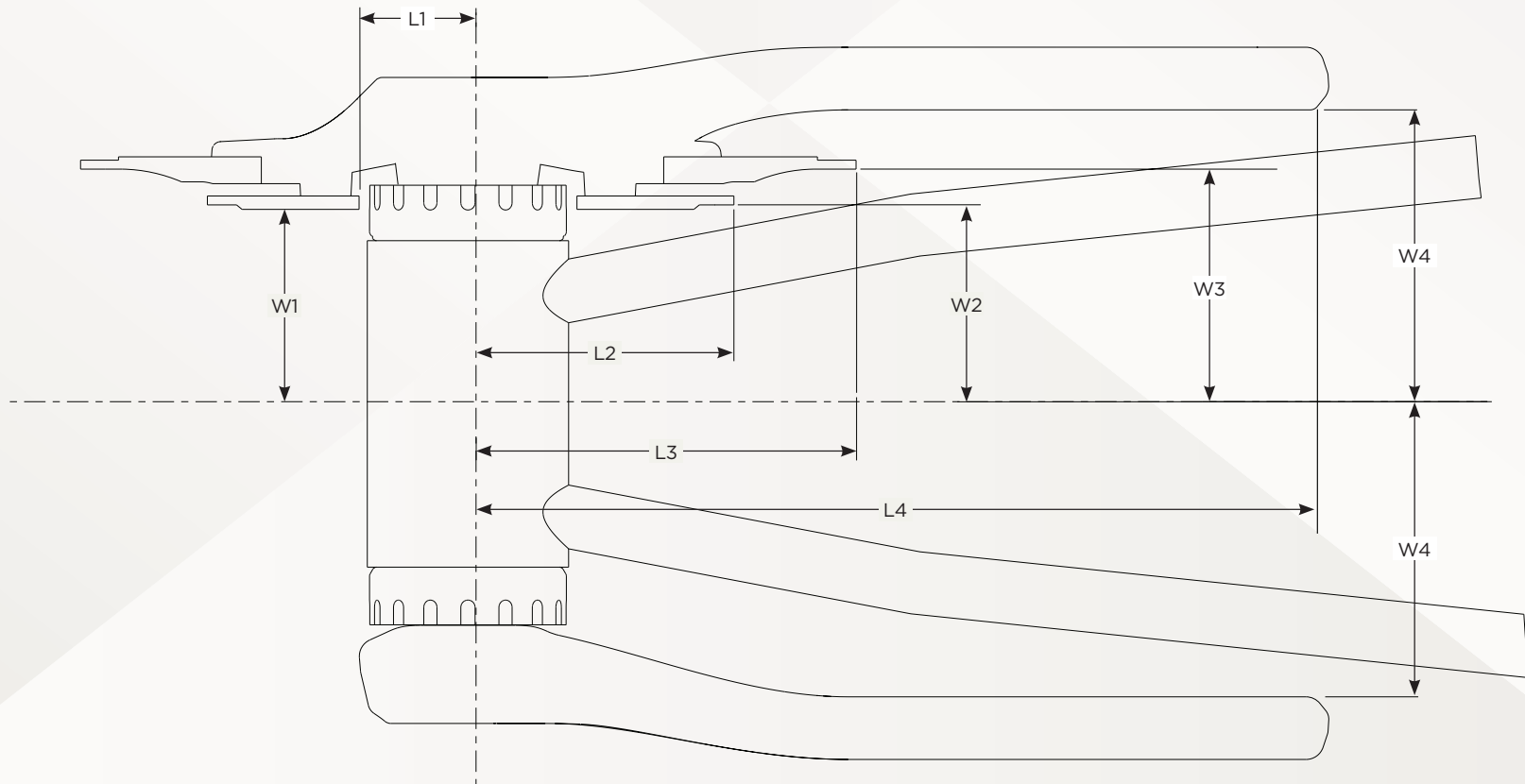

sram.com/xx

